

WITTE FLOOR PLAN

STUDENT STAFF ROOMS

218	230	269	318	330	369	418	430	469	518
530	569	618	630	669	718	730	769	818	830
869	918	930	969	1018	1030	1069	1118	1130	1169

SPECIAL FEATURE ROOMS

If you select one of these rooms and do not need the additional features, you may be asked to move to accommodate a resident who uses these features.

Deaf and Hard of Hearing Accommodations

(strobe fire alarm system)

220	270	320	370	420	470	520	570	620	670
720	770	820	870	920	970	1020	1070	1120	

DOUBLE ROOMS

All rooms.

TWO-WINDOW ROOMS (rooms ending in)

-03	-04	-07	-08	-11	-12	-15	-16	-32	-33
-36	-37	-40	-41	-44	-45	-53	-54	-57	-58
-61	-62	-65	-66	-69	-82	-83	-86	-87	

THREE-WINDOW ROOMS (rooms ending in)

-01	-02	-05	-06	-09	-10	-13	-14	-17	-18
-20	-30	-31	-34	-35	-38	-39	-42	-43	-46
-47	-52	-55	-56	-59	-60	-63	-64	-67	-68
-80	-81	-84	-85	-88	-89				

LAUNDRY ROOMS

Laundry facilities are located in the lower level of the building.

ESSENCE (Black Affinity Living Experience)

3rd floor, Clark House

A living experience focused on supporting students who self-identify within the Black diaspora, designed around allowing Black/African-American students to feel comfortable to be their authentic selves. go.wisc.edu/essence

MULTICULTURAL LEARNING COMMUNITY (MLC)

2nd floor

A learning community celebrating multiculturalism, creativity, and innovation in society that explores issues of human diversity, identity, and social justice. go.wisc.edu/mlc

MIXED COED FLOORS

Women's and men's rooms are integrated throughout the same floor. This means a men's room can be right next door to a women's room. There are separate bathrooms for men and women on the floor.

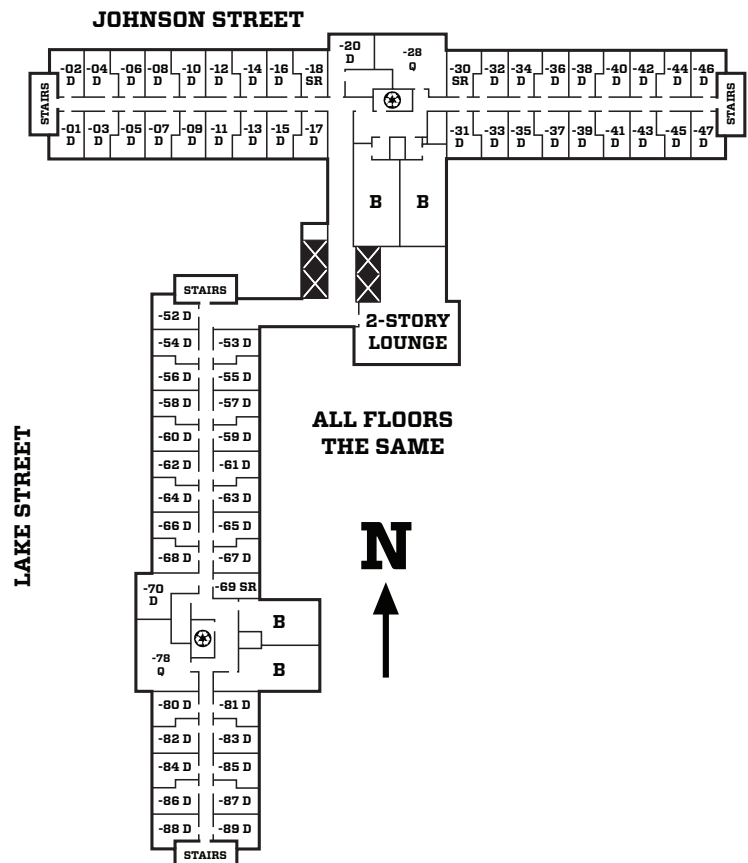

Elevator



Recycling/
Trash Room



Accessible Room
(≈ 36" doorway)



Gender Inclusive
Bathroom

B

Bathroom

SR

Staff Room

S

Single

D

Double

T

Triple

Q

Quad

SWB

Single with Bath

DWB

Double with Bath

TWB

Triple with Bath