

SMITH FLOOR PLAN

STUDENT STAFF ROOMS

2152 2237 3152 3237 4152 4237 5152
5237 6152 6237

SINGLE ROOMS WITH A BATHROOM

2222 3222 4222 5222 6222

SINGLE TYPE A ROOMS (ending in)

-111 -112 -138 -267 -268

SINGLE TYPE B ROOMS (ending in)

-144 -243

DOUBLE TYPE A ROOMS

2114	2135	2153	2154	2156	2163	2165
2214	2253	2254	2265	3113	3114	3126
3133	3153	3154	3163	3224	3235	3236
3265	4113	4133	4135	4136	4153	4154
4163	4175	4224	4236	4253	4266	5126
5135	5136	5153	5214	5236	5253	5254
5265	6114	6125	6165	6214	6224	6253
6254	6265					

DOUBLE TYPE B ROOMS

-137 -251 -252

DOUBLE ROOMS WITH A BATHROOM

-145 -242

TRIPLE ROOMS

2113	2126	2133	2134	2136	2224	2236
2266	3125	3134	3135	3136	3156	3165
3175	3214	3253	3266	4114	4125	4126
4134	4156	4165	4214	4235	4254	5113
5114	5125	5133	5134	5154	5156	5163
5165	5175	5224	5235	5266	6113	6126
6133	6134	6135	6136	6153	6154	6156
6163	6175	6235	6236	6266		

LAUNDRY ROOMS

Laundry facilities are located on the 1st floor.

COED BY CLUSTER

Women and men live on the same floor in clusters of 2-3 rooms that are the same sex and share a bathroom. Floors have multiple men's and women's clusters.

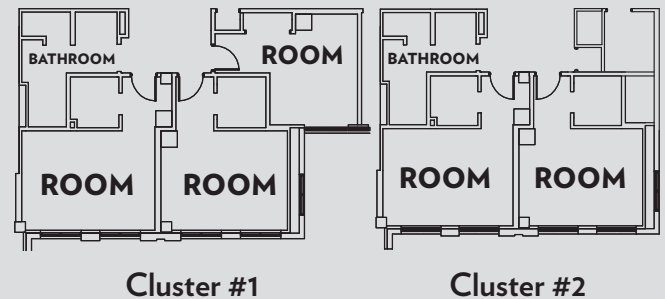

West Clusters (rooms ending in)

Cluster 1:	-111	-113	-115	Cluster 6:	-134	-136	-138
Cluster 2:	-112	-114	-116	Cluster 7:	-153	-155	
Cluster 3:	-123	-125		Cluster 8:	-152	-154	-156
Cluster 4:	-124	-126		Cluster 9:	-163	-165	
Cluster 5:	-133	-135	-137	Cluster 10:	-173	-175	

East Clusters (rooms ending in)

Cluster 1:	-212	-214	Cluster 7:	-263	-265	-267
Cluster 2:	-224	-226	Cluster 8:	-264	-266	-268
Cluster 3:	-233	-235	-237			
Cluster 4:	-234	-236				
Cluster 5:	-251	-253	-255			
Cluster 6:	-252	-254	-256			

SMITH FLOOR PLAN

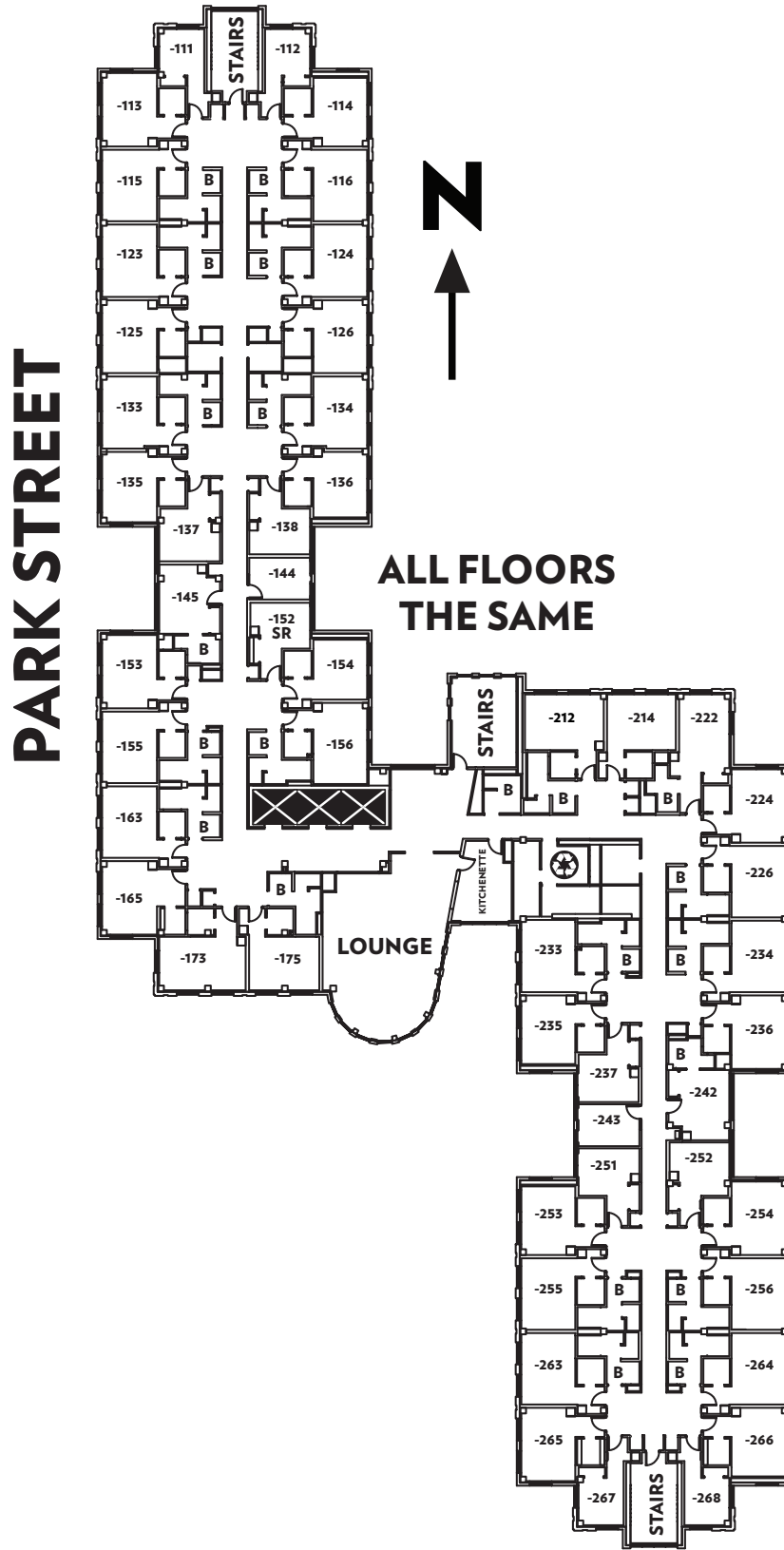

Elevator



Recycling/
Trash Room



Accessible Room
(≈ 36" doorway)

B Bathroom
SR Staff Room

S Single
D Double

T Triple
Q Quad

SWB Single with Bath
DWB Double with Bath