

# COLE FLOOR PLAN

## STUDENT STAFF ROOMS

118 203 303 403

## SPECIAL FEATURE ROOMS

If you select one of these rooms and do not need the additional features, you may be asked to move to accommodate a resident who uses these features.

### Deaf and Hard of Hearing Accommodations

(strobe fire alarm system)

119 125 219 225  
319 325 419 425

### Rooms with Accessibility Accommodations

119

## SINGLE ROOMS

119

## DOUBLE ROOMS

All other rooms.

## BIOHOUSE LEARNING COMMUNITY

4<sup>th</sup> floor – Snow House

A community for students interested in scientific study of living things like plants, animals, health, microbiology, evolution, soil, food, genetics, bioenergy, and much more. [go.wisc.edu/biohouse](http://go.wisc.edu/biohouse)

## LAUNDRY ROOMS

Laundry facilities are located in the lower level.

### COED BY WING (1<sup>st</sup> floor)

Women and men live on the same floor. However, there are divisions via features such as stairwells, elevators, lobbies, or hallway doors. There are separate bathrooms for men and women on each floor.

### MIXED COED FLOORS (second - fourth floors)

Women's and men's rooms are integrated throughout the same floor. This means a men's room can be right next door to a women's room. There are separate bathrooms for men and women on the floor.

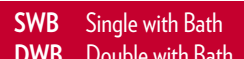
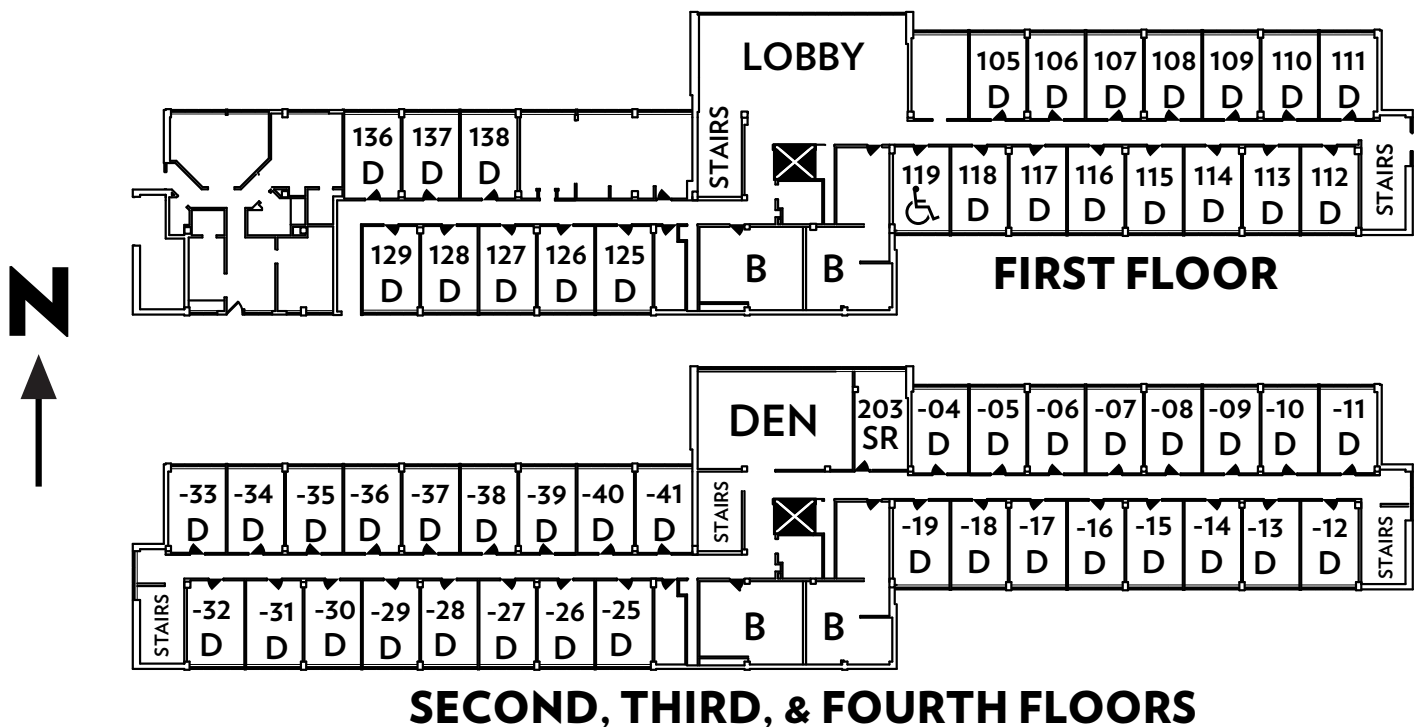

Elevator

Recycling/  
Trash Room

Accessible Room  
(≈ 36" doorway)

B Bathroom  
SR Staff Room

S Single  
D Double

T Triple  
Q Quad

SWB Single with Bath  
DWB Double with Bath