

ADAMS FLOOR PLAN

STUDENT STAFF ROOMS

201 Richardson 202 Siebecker 207 Ochsner
 305 Siebecker 311 Winslow 401 Tarrant

SPECIAL FEATURE ROOMS

If you select one of these rooms and do not need the additional features, you may be asked to move to accommodate a resident who uses these features.

Deaf and Hard of Hearing Accommodations

(strobe fire alarm system)

102 Richardson 106 Noyes 107 La Follette
 117 Winslow 207 Ochsner

Rooms with Accessibility Accommodations

104 Faville 106 Richardson
 112 Winslow 116 Winslow

TRIPLE ROOMS

200 Faville 200 LaFollette 200 Noyes
 200 Ochsner 200 Richardson 200 Siebecker
 200 Tarrant

DOUBLE ROOMS

204 La Follette 205 La Follette 210 Winslow
 305 Ochsner 405 Ochsner

SINGLE ROOMS

All other rooms.

LAUNDRY ROOMS

Laundry facilities are located in the lower level of Noyes House and the first floor of Faville House.

INTERNATIONAL LEARNING COMMUNITY (ILC)

Faville, La Follette, Noyes, Richardson, Siebecker, and Winslow Houses

The ILC brings faculty and students together with the purpose of gaining critical understanding of world cultures. go.wisc.edu/ilc

MIXED COED FLOORS

Women's and men's rooms are integrated throughout the same floor. This means a men's room can be right next door to a women's room. There are separate bathrooms for men and women on the floor.

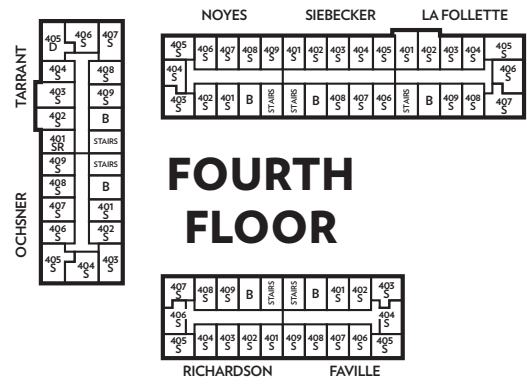
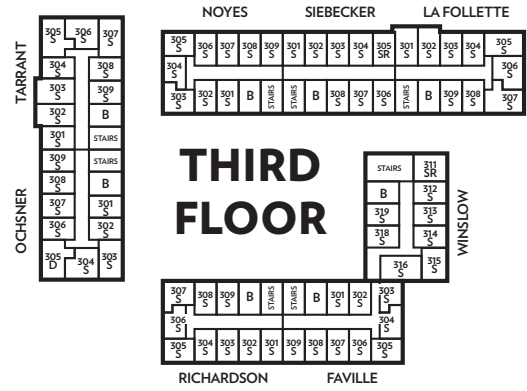
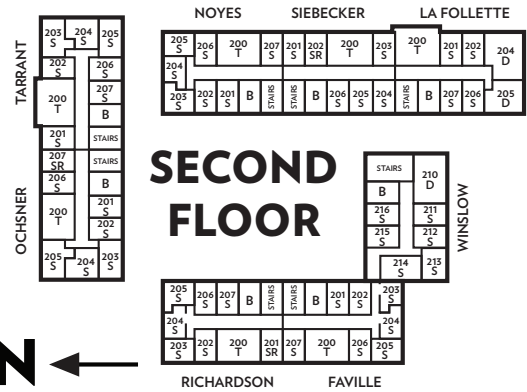
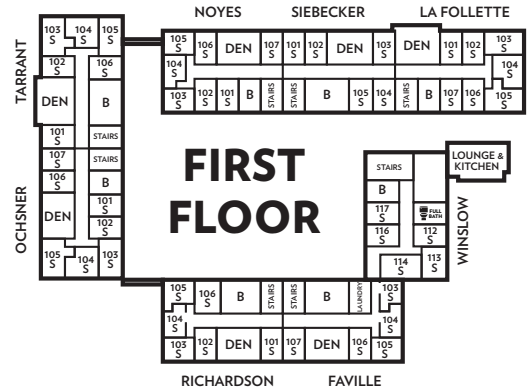

- B Bathroom
- SR Staff Room
- S Single
- D Double
- T Triple
- Q Quad
- SWB Single with Bath
- DWB Double with Bath
- TWB Triple with Bath